

- STEEL BOTTOM ROLLER FOR SQUARE GUIDE RAIL (WITH AXLE)**
- UNTERLAUFENDE STAHLROLLE FÜR FLACHEISENSCHIENE**
- GALET DE ROULEMANT BAS 2L**
- ΠΑΟΥΛΟ ΚΑΤΩ ΚΥΛΙΣΤΕΡΣ ΓΙΑ ΛΑΜΑ (ΜΕ ΑΞΟΝΑ)**

NIKO No	X1.S80	X1.S81
Carrying capacity Kg.	160	250
Dimension D (mm)	45Φ	55Φ
Dimension D1 (mm)	35Φ	45Φ
Dimension d (mm)	M10	M12
Dimension L (mm)	50	59
Dimension B (mm)	21	24
Dimension B1 (mm)	32	39
Dimension e (mm)	10.2	12.3

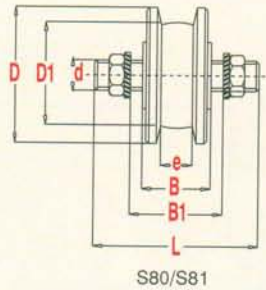

S80/S81



NIKO No	X1.S82	X1.S83	X1.S84	X1.S85	X1.S86
Carrying capacity Kg.	375	500	750	1000	1500
Dimension D (mm)	75Φ	100Φ	125	160Φ	200Φ
Dimension D1 (mm)	63Φ	84Φ	100Φ	130Φ	164Φ
Dimension d (mm)	15Φ	20Φ	25Φ	30Φ	35Φ
Dimension L (mm)	53	59	69	87	108
Dimension B (mm)	33	40	46	58	70
Dimension e (mm)	15.3	20.3	25.3	32	38

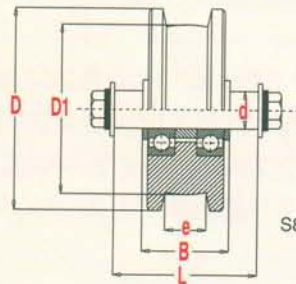

S82/S86

- STEEL BOTTOM ROLLER FOR ANGLE GUIDE RAIL (WITH AXLE)**
- UNTERLAUFENDE STAHLROLLE FÜR WINKELSCHEIENE**
- GALET DE ROULEMANT**
- ΠΑΟΥΛΟ ΚΑΤΩ ΚΥΛΙΣΤΕΡΣ ΓΙΑ ΓΩΝΙΑ (ΜΕ ΑΞΟΝΑ)**

NIKO No	X1.V79	X1.V80	X1.V81
Carrying capacity Kg.	160	180	250
Dimension D (mm)	48Φ	60Φ	60Φ
Dimension D1 (mm)	33Φ	44Φ	44Φ
Dimension d (mm)	M10	M12	M12
Dimension L (mm)	50	59	59
Dimension B (mm)	21	24	24
Dimension B1 (mm)	32	39	39

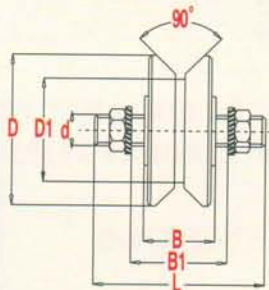

V79/V81



NIKO No	X1.V82	X1.V83
Carrying capacity Kg.	375	500
Dimension D (mm)	80Φ	100Φ
Dimension D1 (mm)	61Φ	81Φ
Dimension d (mm)	15Φ	20Φ
Dimension L (mm)	53	59
Dimension B (mm)	33	40

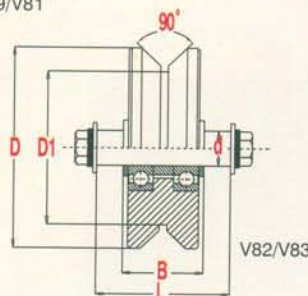

V82/V83

🇬🇧 STEEL BOTTOM ROLLER FOR SQUARE GUIDE RAIL (WITH SIDE PLATES)

🇩🇪 UNTERLAUFENDE STAHLROLLE MIT SEITENPLATTEN FÜR FLACHEISENSCHIENE

🇫🇷 GALET DE ROULEMANT BAS 2L AVEC PLATINE LATÉRALE

🇬🇷 ΠΑΟΥΛΟ ΚΑΤΩ ΚΥΛΙΣΕΩΣ ΓΙΑ ΛΑΜΑ (ΜΕ ΠΛΑΚΕΣ)

NIKO No.	X1.S71	X1.S72	X1.S73	X1.S74
With Roller No.	X1.S81	X1.S82	X1.S83	X1.S84
Carrying capacity Kg.	250	375	500	750
Dimension D (mm)	55Φ	75Φ	100Φ	125Φ
Dimension B (mm)	32	41	50	56
Dimension B1 (mm)	24	33	40	46
Dimension L (mm)	180	180	210	210
Dimension s (mm)	4	4	5	5
Dimension e (mm)	18	25	35	42
Dimension H (mm)	100	100	120	120

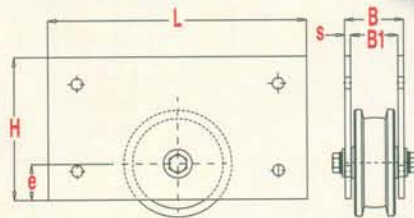

🇬🇧 STEEL BOTTOM ROLLER FOR SQUARE GUIDE RAIL (WITH BRACKETS)

🇩🇪 UNTERLAUFENDE STAHLROLLE FÜR FLACHEISENSCHIENE

🇫🇷 GALET DE ROULEMANT BAS 2L AVEC PLATINE

🇬🇷 ΠΑΟΥΛΟ ΚΑΤΩ ΚΥΛΙΣΕΩΣ ΓΙΑ ΛΑΜΑ (ΜΕ ΦΛΑΝΤΖΕΣ)

NIKO No.	X1.S60	X1.S61	X1.S62	X1.S63	X1.S64
With Roller No.	X1.S80	X1.S81	X1.S82	X1.S83	X1.S84
Carrying capacity Kg.	160	250	375	500	750
Dimension D (mm)	45Φ	55Φ	75Φ	100Φ	125Φ
Dimension D1 (mm)	35Φ	45Φ			
Dimension B (mm)	20	19.5			
Dimension e (mm)	10.2	12.3			
Dimension C (mm)	28	28			

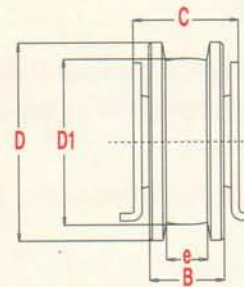

🇬🇧 STEEL BOTTOM ROLLER FOR SQUARE GUIDE RAIL (WITH BASE)

🇩🇪 UNTERLAUFENDE STAHLROLLE MIT LASCHE FÜR FLACHEISENSCHIENE

🇫🇷 GALET DE ROULEMANT BAS 2L

🇬🇷 ΠΑΟΥΛΟ ΚΑΤΩ ΚΥΛΙΣΕΩΣ ΓΙΑ ΛΑΜΑ (ΜΕ ΒΑΣΗ)

NIKO No.	X1.S50	X1.S51	X1.S52	X1.S53	X1.S54
With Roller No.	X1.S80	X1.S81	X1.S82	X1.S83	X1.S84
Carrying capacity Kg.	160	250	375	500	750
Dimension H (mm)		59			
Dimension L (mm)		100			
Dimension e (mm)		22			
Dimension C (mm)		28			

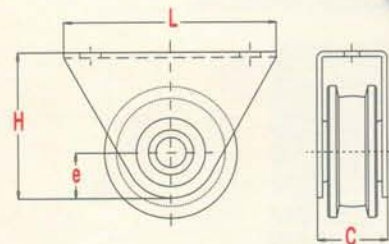

- STEEL BOTTOM ROLLER FOR ANGLE GUIDE RAIL (WITH SIDE PLATES)**
- UNTERLAUFENDE STAHLROLLE MIT SEITENPLATTEN FÜR WINKELSCHIENE**
- GALET DE ROULEMANT AVEC PLATINE LATÉRALE**
- ΡΑΟΥΛΟ ΚΑΤΩ ΚΥΛΙΣΕΩΣ ΓΙΑ ΛΑΜΑ (ΜΕ ΠΛΑΚΕΣ)**

NIKO No	X1.V70	X1.V71	X1.V72	X1.V73
With Roller No.	X1.V80	X1.V81	X1.V82	X1.V83
Carrying capacity Kg.	180	250	375	500
Dimension D (mm)	60Φ	60Φ	80Φ	100Φ
Dimension B (mm)	32	32	41	50
Dimension B1 (mm)	24	24	33	40
Dimension L (mm)	180	180	180	210
Dimension s (mm)	4	4	4	5
Dimension e (mm)	18	18	25	35
Dimension H (mm)	100	100	100	120

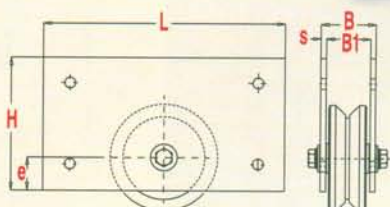

- STEEL BOTTOM ROLLER FOR ANGLE GUIDE RAIL (WITH BRACKETS)**
- UNTERLAUFENDE STAHLROLLE MIT FLANSCH FÜR WINKELSCHIENE**
- GALET DE ROULEMANT AVEC PLATINE**
- ΡΑΟΥΛΟ ΚΑΤΩ ΚΥΛΙΣΕΩΣ ΓΙΑ ΓΩΝΙΑ (ΜΕ ΦΛΑΝΤΖΕΣ)**



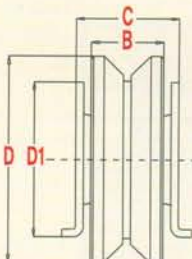

NIKO No	X1.V59	X1.V60	X1.V61	X1.V62	X1.V63
With Roller No.	X1.V79	X1.V80	X1.V81	X1.V82	X1.V83
Carrying capacity Kg.	160	180	250	375	500
Dimension D (mm)	48Φ	60Φ	60Φ	80Φ	100Φ
Dimension H (mm)	34	34			
Dimension B (mm)	20	19.5			
Dimension C (mm)	28	28			

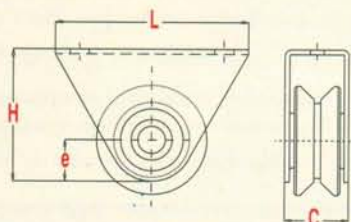

- STEEL BOTTOM ROLLER FOR ANGLE GUIDE RAIL (WITH BASE)**
- UNTERLAUFENDE STAHLROLLE MIT LASCHE FÜR WINKELSCHIENE**
- GALET DE ROULEMANT**
- ΡΑΟΥΛΟ ΚΑΤΩ ΚΥΛΙΣΕΩΣ ΓΙΑ ΓΩΝΙΑ (ΜΕ ΒΑΣΗ)**

NIKO No	X1.V49	X1.V50	X1.V51	X1.V52	X1.V53
With Roller No.	X1.V79	X1.V80	X1.V81	X1.V82	X1.V82
Carrying capacity Kg.	160	180	250	375	500
Dimension H (mm)		59	59		
Dimension L (mm)		100	100		
Dimension e (mm)		22	22		
Dimension C (mm)		28	28		



-  **STEEL BOTTOM ROLLER FOR GUIDE PLATE (WITH AXLE)**
-  **UNTERLAUFENDE STAHLROLLE FÜR FLACHEISENSCHIENE**
-  **GALET DE ROULEMANT**
-  **ΡΑΟΥΛΟ ΚΑΤΩ ΚΥΛΙΣΕΩΣ ΓΙΑ ΛΑΜΑ**

NIKO No.	X1.S42	X1.S43	X1.S44	X1.S45
Carrying capacity Kg.	200	270	400	500
Dimension D (mm)	100Φ	120Φ	140Φ	160Φ
Dimension D1 (mm)	80Φ	100Φ	120Φ	140Φ
Dimension d (mm)	15Φ	15Φ	20Φ	20Φ
Dimension L (mm)	60	60	60	60
Dimension B (mm)	35	35	35	35
Dimension e (mm)	14	14	14	14

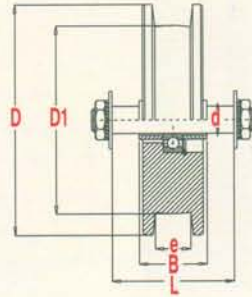

-  **IRON CAST BOTTOM ROLLER**
-  **UNTERLAUFENDE ROLLE AUS TEMPERGUSS**
-  **GALET DE ROULEMANT**
-  **ΡΑΟΥΛΟ ΚΑΤΩ ΚΥΛΙΣΕΩΣ ΜΑΝΤΕΜΕΝΙΟ**

NIKO No.	X1.M80	X1.M81	X1.M83	X1.M85
Carrying capacity Kg	75	90	125	180
Dimension D (mm)	75Φ	90Φ	120Φ	160Φ
Dimension D1 (mm)	59Φ	74Φ	102Φ	140Φ
Dimension d (mm)	10	10	12	17
Dimension L (mm)	40	40	50	52
Dimension B (mm)	32	32	40	40
Dimension e (mm)	10	10	11	13

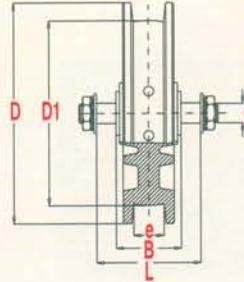

-  **Detailed brochures on applications shown in the Technical Catalogue including various products stated here below, are available on request.**

It is the policy of our company to continually develop and improve the NIKO range of products. Thus, we reserve the right to amend details and dimensions without obligation.

-  **Fragen sie uns nach analytischen prospekten für anwendungen dieses technischen katalogs sowie der anderen unseren produktgruppen die weiter unten erwähnt werden.**

Sämtliche Masse und Gewichtsangaben sind unverbindlich, Konstruktionänderungen vorbehalten.

-  **N'hésitez pas à nous demander des détails sur les installations supplémentaires contenues dans notre catalogue technique ainsi que sur tout autre produit mentionné.**

Nous conservons le droit de changer les détails et les dimensions techniques.

-  **Ζητείστε μας αναλυτικά προοπτικά εφαρμογών του παρόντος τεχνικού καταλόγου καθώς και των υπολοίπων ομάδων προϊόντων μας που αναφέρονται παρακάτω.**

Διατηρούμε το δικαίωμα αλλαγής διαστάσεων και τεχνικών προδιαγραφών.